

**FIXED ROOF LIGHT SECTION**

The outer kerb dimensions should match the same dimensions as the roof light size ordered e.g. a 1000mm x 1000mm roof light requires the outer kerb dimensions to be 1000mm x 1000mm. The recommended kerb depth / thickness is 80mm. The kerb should have a minimum of a 5-degree pitch.

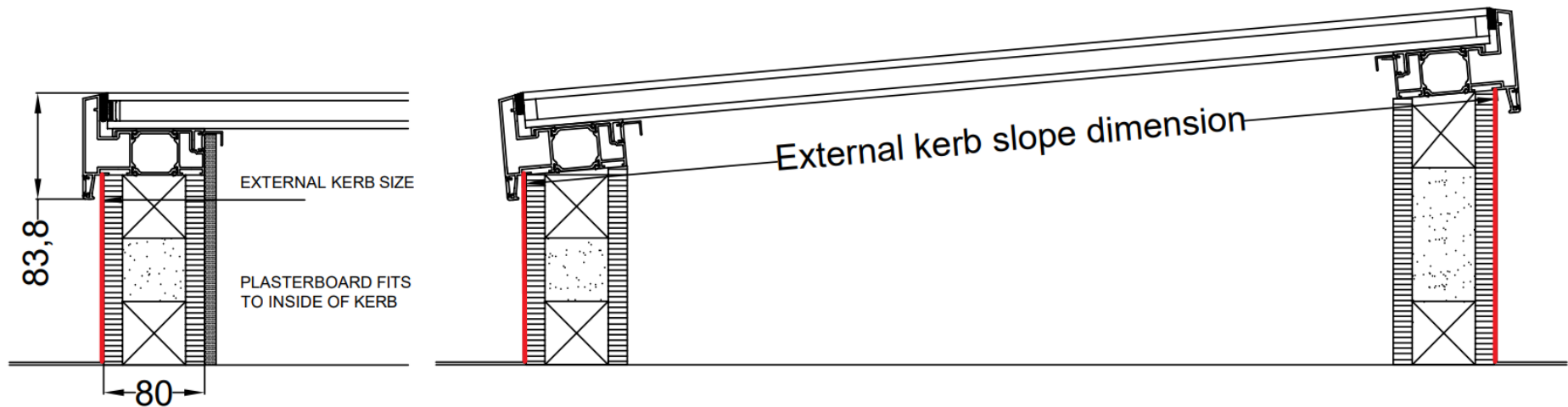

**SIDE ELEVATION**